



emotions®
kitchen range specifications

PORCELANOSA KITCHENS

why working with PORCELANOSA KITCHENS

Production CAPACITY

GAMADECOR's furniture manufacturing facilities cover an area of 135,000 m2, with a work system conceived to adapt the work load to its production capacity.

Cutting-edge TECHNOLOGY and DESIGN

GAMADECOR uses state-of-the-art machinery to manufacture its furniture. It also conducts ongoing studies of design trends, as demonstrated by the prestigious international design awards that it has received, such as Good Design, Red Dot or If design.

Made in EUROPE

GAMADECOR's furniture is fully manufactured in Spain and the cabinet hardware for all its products is made by leading European brands. All the board that it uses are sourced from controlled forests. This guarantees that it is harvested from responsibly managed forests in accordance with sustainable tree-felling criteria.

AFTER-SALES service

GAMADECOR is committed to offering quality and first-class service to customers. To meet this goal, it offers a speedy, efficient after-sales service through all official distributors of PORCELANOSA GRUPO in the almost 100 countries in which it operates.

The BRAND

The assurance of PORCELANOSA Grupo, a major business group that has forged a leading reputation both in Spain and abroad, supplying products to more discerning market segments.

ALL-ROUND consultancy advice

PORCELANOSA Grupo is present in almost 100 countries worldwide, offering an all-round design, onsite supervision and assembly service, with total dedication to the task thanks to its extensive team of staff.

A choice of PRODUCT RANGES

GAMADECOR offers a choice of three different kitchen collections and their corresponding models to meet differing kitchen design requirements. In addition to its kitchen furniture, GAMADECOR also manufactures a wide range of bathroom and living furniture, wardrobes and walk-in closets.

Assured QUALITY

Each of PORCELANOSA Grupo's different companies offer the assurance of superior quality, endorsed by nearly 50 years' experience manufacturing top-quality products able to pass the strictest resistance and stress tests.





ECOLOGICAL commitment

Sustainability – that is achieving a balance between human development and the conservation of natural resources – is a key priority for GAMADECOR. It is one of the main driving forces behind initiatives like the implementation of different environmental management systems over the years, ongoing improvements to the efficiency of the company's production systems, and the progressive elimination of plastic from its packaging. This has led to a dramatic reduction in the environmental impact that GAMADECOR makes, and the company aims to continue reducing it through ongoing improvements in the field of sustainability.

On the one hand, an Environmental Management System has been set in place, based on the international ISO 14001 standard. Thanks to this system, environmental aspects of all GAMADECOR's activities and their associated impacts can be more easily identified and improved on, in addition to fostering environmental protection and the prevention of pollution.

On the other, GAMADECOR is an FSC® certified company. This means that its raw materials are certified as complying with the FSC® chain of custody system, hence ensuring that all the wood used in the company's furniture comes from properly managed forests where trees are felled in accordance with sustainable criteria.

Carbon footprint analyses are another important initiative in the field of environmental management. They consist of measuring all the company's direct and indirect greenhouse gas emissions from all walks of its activities so that specific measures can be introduced to reduce and/or offset the impact of greenhouse gas emissions.



More ENVIRONMENTALLY FRIENDLY raw materials

The particleboard in GAMADECOR's cabinets is made of 72% recycled content, with the circular economy accounting for 49% and sawmill residues (by-products) for 23% of this figure.

This 49% from the circular economy is made up of furniture, doors and other wood remains that are taken to recycling centres.

By using recycled material, GAMADECOR avoids the felling of over 14.334 trees a year, which are capable of absorbing 4.796 tons of CO2, equivalent to over 2.940 flights between Madrid and New York.

All GAMADECOR's furniture contributes to the circular economy, because the materials can be re-used to make new furniture.

When the board is cut and processed, 86,000 kg of extremely clean sawdust is generated. This is used as BIOMASS (renewable energy). All the remnant pieces of chipboard (1,400 tons) are ground up again and mainly re-used in the manufacture of new board.

 72% RECYCLED MATERIAL

=

 14.334 SAVED TREES

=

CO₂ 4.796 TN ABSORBED BY TREES

=

 2.940 FLIGHTS: MADRID → NEW YORK

NOTE: These figures were calculated using Gamadecor's production statistics for 2019.

Presentation of *emotions*® kitchens.

emotions® is a trendsetting collection, with some of the most exclusive features on the market. This is GAMADECOR's most select range of kitchen furniture, destined to play a prominent role in deluxe settings.



MODULES ADAPT to household appliances.

Oven or refrigerator column modules 100% configurable so a precise integration is achieved with a more refined aesthetics of any appliance because does not require trimming or finishing to cover gaps in standard sizes.

Also, continuing with the minimalist design, a concealed ventilation pedestal has been designed, in order to replace the unattractive ventilation grilles. This pedestal supports the weight of the refrigerator and favours ventilation, increasing its useful life.



MADE IN EUROPE, using top-quality processes.

PORCELANOSA's kitchens are fully manufactured in Europe in accordance with meticulous quality controls. Top-range cabinet hardware, made by leading European brands, is used in all its products.

Rugged and stylish ALUMINUM PLINTHS.

The plinths of *emotions*® kitchens have a minimum height of 6 cm, thus allowing for the possibility of higher base units and more storage space. Because the plinths are set back from the front of the units, they are concealed, creating the impression of a floating kitchen.

The plinths are made of extruded aluminium, a material with a high resistance to rust. They also feature a rubber seal along the bottom to protect them from small spillages of water. The plinths can be removed since they are clipped to the legs of the units, thus making it easy to clean the space underneath.



WIDE RANGE OF options for interior equipment.

The *emotions*® kitchen collection features a wide range of different organizational and storage solutions. These include functional drawer organizers made of oak or steel to match the rest of the drawer and pull-out fittings to optimize the available space, making it easier to store objects and to reach any utensil or food product at any time.

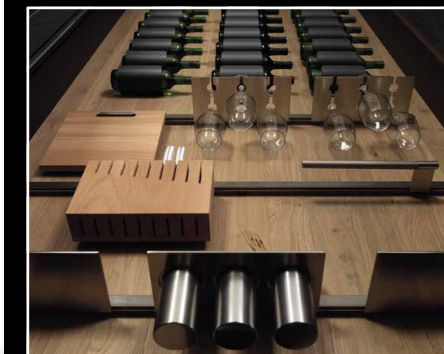

In conjunction, the smooth or textured laminate, high-gloss or nanotechnological HPL, matt or gloss lacquer, and smooth or rustic-look veneer finishes in the emotions® collection all offer an extensive choice of colours.

SMOOTH LAMINATE finishes, with elegant finer details.

-e1 smooth laminate:

Fronts faced with monochrome melamine paper, made of uniform-coloured laminated melamine resin. This ensures a discrete seam around the edges, with no black line. Because the doors are laser edged with polypropylene edgebanding, a more watertight, longer-lasting, almost invisible seam is achieved. The interiors of the units come in the same choice of finishes.

Realistic TEXTURED LAMINATE finishes.

-e2 textured laminate:

Fronts faced with an innovative monochrome or wood-effect melamine paper, made using "synchronised pore" technology, where the pores and indentations are synchronised with the underlying decorative layer to ensure highly realistic end results. Like the e1 laminates, the fronts are laser edgebanded.

NANOTECHNOLOGICAL HPL, anticipating the finishes of the future.

-e3 Ghost matt nanotechnological HPL:

A cutting-edge finish, made with smudge-proof matt nanotechnological HPL able to repel fat and grease. The surface can also be heat-treated to repair any surface scratches, thus conserving its initial appearance for much longer.

HIGH-GLOSS HPL, a superb imitation of a glossy lacquer finish.

-e3 Glass high-gloss HPL:

Glossy HPL, with tightly stretched paper to minimize any wavy surface effect. Thanks to the use of this technique and laser edgebanding, an almost identical replica of a glossy lacquer finish can be achieved.



CUTTING-EDGE LACQUER finishes in a wide spectrum of warm or cool colours.

-e4 matt and e5 gloss lacquer:

GAMADECOR's lacquer finishes are applied using state-of-the-art machinery and strict controls of different variables so as to ensure a broad colour spectrum. The edges are slightly rounded to boost their impact resistance and ensure a more perfect seam. Thanks to the chemical composition of the paints, the matt lacquers have a diamond hard effect so as to avoid surface scratches, while the glossy lacquers are given an additional polish to achieve their 100 GLOSS mirror-like shine.

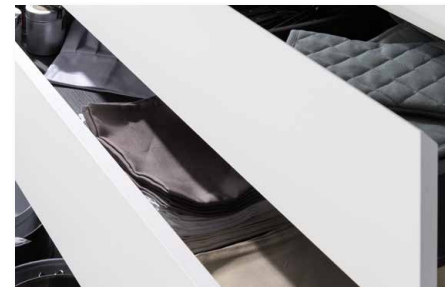

WOOD VENEER finishes with a unique personality.

-e6 smooth veneer:

The emotions® wood finishes are made of wood strip veneers, specially chosen for their highly attractive, distinctive wood grain pattern.

-e7 rustic-look veneer:

These finishes are similar to the above, with the addition of one extra process in which any weaker surface wood is removed to highlight the wood grain texture of the hard wood. This leads to an elegant rustic vintage look.

XTONE AND KRION®, state-of-the-art surfaces.

Fronts that comprise a sophisticated aluminium profile onto which an Xlight or Krion® sheet is bonded. These high-performance claddings ensure long-lasting fronts combined with a cutting-edge design.

A wide choice of SUPERIOR-LOOKING HANDLES.

The emotions® collection offers a wide variety of options for handles, both front handles and integrated handles, adaptable to all tastes and needs, giving the kitchen a more modern and minimalist look.

The laminated door fronts' integrated handles are made using innovative Softforming technology so as to mould the edge of the board into the desired shape. This leads to kitchens with a clear-cut design that was hitherto impossible with such materials.



Technical specifications

Made with WATER-RESISTANT board for durability.

The carcasses of emotions® kitchen units are made of water resistant E-rated particleboard, with a high resistance, low formaldehyde emissions and thickness of 19 mm to guarantee a higher bending strength. Because they are water resistant, they are more resistant to moisture, providing greater protection and making them less vulnerable to the effects of water over the passage of time. The doors are laser-edged with polypropylene edgebanding to ensure a more watertight, long-lasting, almost invisible seam.

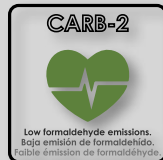
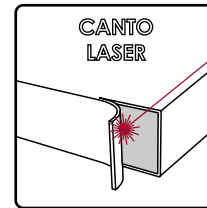

CARB-2 / EPA rated board with ultra low emission of formaldehyde.

The panels used in carcasses are even more health-conscious thanks to the lowest formaldehyde emission certified in the CARB II (ATCM 93120) / EPA (US EPA TSCA Title VI) in Formaldehyde emission.

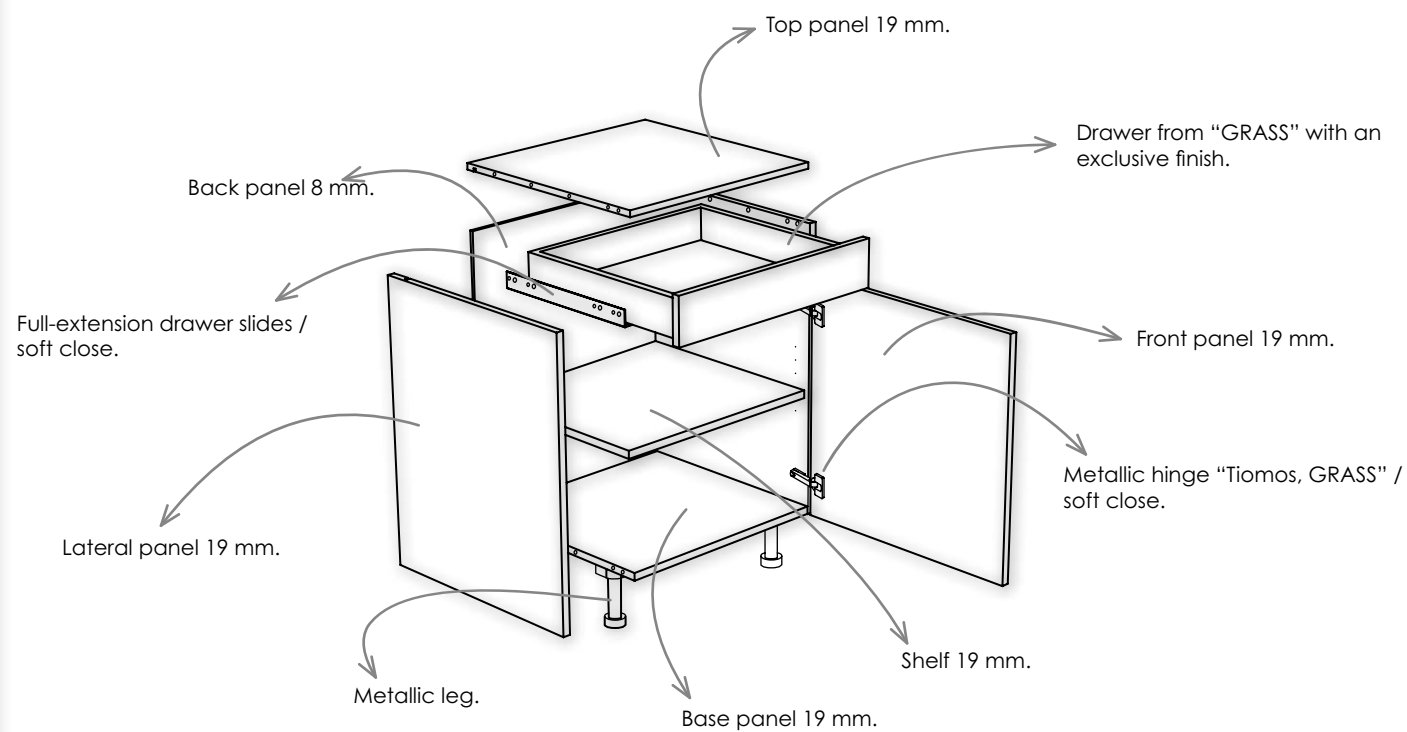

MAXIMUM STABILITY guaranteed.

emotions® kitchens by GAMADECOR guarantee robust resistance and greater stability thanks to their construction, using hard wood dowels to assemble the components, glued at the same time as the thicker-than-normal (8mm) back panel is inserted. The end result is a compact, highly stable ensemble. The weight is also equally distributed through the side panels and base to the stainless steel height-adjustable legs. This prevents the unit from gradually sagging due to the weight of the countertop.

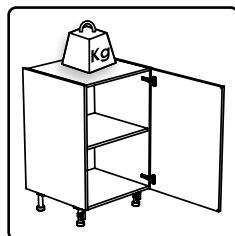

Top-quality cabinet hardware by LEADING EUROPEAN BRANDS

emotions® kitchens feature the latest models in cabinet hardware by leading European brands. This leads to kitchens with cutting-edge mechanisms, made of top-quality materials, with the guarantee of manufacturers that have been innovating for decades and improving the resistance and performance of these systems.



Drawers with an EXCLUSIVE finish.

The drawers and deep drawers are made using the top-range Vionario model by Grass, with the thinnest aluminium sides on the market, thus providing added storage capacity. The drawers have a finish exclusive to GAMADECOR's emotions® kitchen range, with full-extension soft-close drawer runners. This protects the unit from impacts if the drawers slam shut, preventing it from breaking before it reaches the end of its useful life. The drawers can also withstand weights of up to 80 kg and they have passed the most demanding tests, with open-close cycles that surpass the 60,000 cycles required in the corresponding standard.



Hinges with ADJUSTABLE DAMPING.

Top-range Tiomos hinges by Grass are used for the doors. The hinges are fully metallic and three dimensionally adjustable, with a high resistance to moisture, a simple clip system for mounting or removing the doors and, like the drawers, they incorporate a soft-close system to protect the door from impacts. This model of hinge also features an easily accessible adjuster mechanism, with three positions, to adjust the strength needed to close the door as required.

CONCEALED shelf supports.

The inner shelf supports of emotions® kitchen units are the most sophisticated elegant ones on the market: the Mori model by Italiana Ferramenta. They are embedded in the shelves and the different heights of the shelves are marked on the carcass without perforating it, ensuring elegant, clean, lightweight-looking interiors.

MORE RESISTANT cabinet hangers.

The wall units are hung from the wall using two top-range, fully metallic HETAL hangers, each able to withstand a weight of up to 65 kg (130 kg per unit). These fittings are concealed behind the back of the unit and they distribute the weight evenly between the top and sides to ensure greater stability. They can be regulated from inside the unit to make it easier to position.



emotions[®]

kitchen range specifications

GAMADECOR
PORCELANOSA Grupo

Gama-decor, S.A.U.:
Carretera Vila-real - Puebla de Arenoso CV-20 km 1,7
Aptdo/box 179 - 12540
Vila-real - Castellón - Spain

Teléfono: +34 964 506 850
Fax.: 964 506 596 Nacional
+34 964 506 597 International

www.gama-decor.com
e-mail: gama-decor@gama-decor.com

© Copyright GAMA-DECOR, S.A.U. All rights reserved.

GAMADECOR reserves the right to modify or cancel the information that appears in this catalogue concerning all aesthetic and technical aspects as well as pricing.

GAMADECOR reserves the right to modify the characteristics of its products without prior notice.

The finishes shown are only for informative purposes; all rights are reserved due to the possible differences resulting from printing. For that reason, the photos displayed of the products are not to be deemed contractually binding.

All rights are reserved for possible errors within the texts which appear in the catalogue due to the composition or insertion of the pages.

This catalogue is informative only.



The mark of
responsible forestry
FSC® C115389

